

Theta Digital

Preprogrammed & Learning Remote Control

Owner's Manual



Congratulations!

Congratulations on purchasing Theta Digital's 7-Component Pre-Programmed and Learning remote control. You now have the power to control your entire home entertainment system with one easy--to--use remote. The Theta Digital remote can be used with thousands of audio/video components because of the extensive library of codes that has already been programmed into the remote. So... get ready to sit back, relax, and simplify your home entertainment experience.

This Owner's Manual is designed to assist you in programming your Theta Digital remote to work with your components by guiding you through an easy step-by-step process. Everything you need to know about programming the Theta Digital remote is contained in this Manual.



Theta Digital

A Division of Amplifier Technologies, Inc.

1749 Chapin Road, Montebello, CA 90640

(323) 278-0001 www.thetadigital.com

Info@thetadigital.com

Table of Contents

Getting Started - Overview

- Control up to 7 Components5
- Activating Component Buttons5
- Learning Capability.....5
- AUX Function.....6
- Light Button.....6
- Battery Installation.....6
- Low Battery Warning.....6
- Couch Mode6

Special Advanced Features

- MacroString™ & Other Macros.....7
- “My Favorites” - Favorite Channels.....7
- LevelControl™ & Other “Punch Throughs”7

Keypad Layout & Button Functions8

Programming THETA DIGITAL REMOTE

- Using Pre-programmed Codes.....9
- Quick Set-Up Method.....9-10
- Three-Digit Code Entry Method.....11-13
- Auto-Search Method14-15

Programming Theta Digital remote Using the Learning Method.....16-18

- AUX Function: Programming a 7th Component.....19

Finding a Component's Set-Up Code Number.....19-20

Programming Special Advanced Features

- MacroString™ Total System On/Off21-22
- “My Favorites” – Favorite Channels.....23-24
- LevelControl™ Total System Volume Control.....25-26

- Channel Control “Punch Through.....27
- Transport Control “Punch Through”28
- OSD (On-Screen Display) Control “Punch Through”29

Erasing Commands Overview.....30

- Erasing a Single Learned Command30
- Erasing All Learned Commands from One Component.....31
- Erasing MacroString & Other Macro Commands32
- Erasing LevelControl & Other “Punch Through” Commands.....33
- Factory Reset34

Pre-Programmed Code Tables35

- AUDIO36-37
- DVD37-38
- VCR/DVR.....39-40
- AUX40-41
- CD41-42
- TV42-45
- CABLE/SAT45-46

FAQs47

Warranty48

Specifications48

Getting Started Overview

Control up to 7 Components

The Theta Digital remote control is designed to control up to seven different Audio/Video components and operate virtually all brands of AUDIO, TV, DVD, VCR/DVR, CD, SAT/CABLE and AUX (Light, Music Server, etc.) components.

Activating Component Buttons

Once you have programmed the Theta Digital remote for all of your components, all you need to do is press a component button and all the buttons on the Theta Digital remote will work with that component. For example, when you press the TV component button, all the buttons on your Theta Digital remote will operate your TV. If you press the DVD component button, all the buttons on the Theta Digital remote will operate your DVD.

Each time you press any of the buttons on the remote, the LED light in the component button will light up to indicate which component you are controlling.

TV BUTTON

Learning Capability

The Theta Digital remote has the ability to “learn” functions from the original remote controls of other manufacturers, even if they are not in the Pre-programmed database.

AUX Function

The AUX (Auxiliary) button is designed to operate a 7th audio/video component that you may have in your system... such as a TIVO, a second VCR or DVD, or an additional audio component. The default code for AUX operates Theta Digital's Generation VIII Stereo Digital to Audio Converter.

Light Button

The Theta Digital remote features a fully backlit keypad for ease of use in low light or darkened viewing conditions. Press the LIGHT button to backlight all the keypad buttons. Press again to turn off (or simply wait 10 seconds for automatic shut-off).

Battery Installation

Press the tab and remove the cover of the battery compartment located in the back of your remote. Insert the two AA Alkaline batteries (included in the package) making sure to match the positive (+) and negative (-) symbols as shown in the diagram. Place the cover back over the battery compartment.

Low

Warning

When the batteries are low, the remote will blink three times when you press [ON]

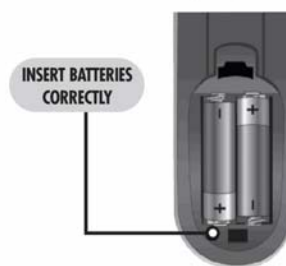

Battery

When the batteries are low, the remote will blink three times when you press the POWER button.

Couch Mode

The Theta Digital remote is designed to automatically turn itself off if a button is pressed for more than 30 seconds. This prevents battery power from being depleted should the remote accidentally slip between the couch cushions.

Special Advanced Features

The Theta Digital remote also offers the following special advanced features that can offer you many time-saving conveniences:

MacroString™ & Other Macro Buttons

MacroString is a unique feature that enables you to turn all your components ON or OFF, all at the same time, simply with the press of one button. The Theta Digital remote has 13 Macro buttons that are designed to store up to 20 commands in each button. Pressing any one of the Macro buttons will send out the series of commands that are stored in that button.

“My Favorites” (Favorite Channels)

This is one of the most desirable features of the Theta Digital remote control. Once it's set up, you can select one of four favorite channels with the press of one button – without the need to type in a channel number. So, whether it's CNN or the Food Network, your favorite viewing spot is just one click away.

LevelControl™ & Other “Punch Throughs”

LevelControl Volume Control is a dynamic feature that gives you total volume control over all the components in your system, even those that do not have their own built-in volume control, such as TIVO, DVD and VCR... saving you the hassle and inconvenience of constantly needing to switch between component modes on the remote. As an example, in order to increase the volume while watching a DVD, you would typically have to pick up the TV remote control to increase the volume. With the Theta Digital remote, you do not even have to press the TV component button. Once you program LevelControl in your DVD mode, you will automatically have TV volume control in DVD mode.

LevelControl is what is called a “Punch Through” feature and is not limited to volume control. It can also be applied to Channel Control, Transport Control, and OSD Control.

Keypad Layout & Button Functions

ON
Allows you to turn the selected component on and off.

SYSTEM OFF
Designed to send Power On/Off commands for up to seven components with one button press.

AUD, CD, VCR, AUX, TV, DVD, SAT/CABLE
Used to select the component you want to operate and signals remote control activity.

INPUT
Selects the video source from available components.

PREVIOUS CHANNEL
Returns to the previously tuned channel through the SAT/Cable Set Top Box.

VOLUME
Raises or lowers the sound volume.

GUIDE
Displays the Program Guide Listings provided by the Cable or Satellite Service Provider.

MENU
Displays the Applications Menu through the Cable Set Top Box.

CURSOR NAVIGATION PAD
Used for programming steps and on-screen navigation and highlighting.

TRANSPORT CONTROLS
Perform standard VCR and DVD functions when in VCR and DVD mode, or VOD (Video-On-Demand) and DVR (Digital Video Recorder) functions when in Cable mode.

MY FAVORITES
Custom-programmable Favorite Channel Buttons

CHANNEL
Selects the next higher or lower channel.

MUTE
Silences the Audio. Press to activate. Press again to restore sound to the previous level.

INFO
Displays information about the program currently playing or highlighted in the Program Guide (see GUIDE).

EXIT
Exits from current screen.

SELECT
Selects highlighted screen options.

SKIP-/+
Skip forward or backward a whole day in the Program Guide.

NUMBER PAD
Use to enter code numbers for programming components and to enter channel numbers to tune in channels. Also used to make numeric entries on on-screen menus. The alpha labels on the keys refer to Audio component functions that can be accessed with the respective keys.

LIGHT BUTTON
Press to back-light all keypad buttons. Press again to shut off (or simply wait 10 seconds for automatic shut-off).

Programming the Theta Digital Remote using Pre-Programmed Codes

There are three ways you can program your Theta Digital remote using the component brand codes that are pre-programmed into the remote.

- Quick Set-Up Method
- Three-Digit Code Entry Method
- Auto--Search Method

The Quick Set-Up Method is a unique new feature that enables the fastest and easiest set-up by using one-digit codes for up to 10 major brands for each component.

The Three-digit Code Entry Method allows you to set-up the Theta Digital remote using 3-digit codes for component brand names. It is also a fast and easy way to program the remote. The Auto-Search Method scans through all the brands in the remote control, one at a time. It should be used when either the Quick Set-Up or Three-Digit Code Entry Methods do not work.

* * *

Quick Set-Up Method

STEP 1: Manually or using your old remote, turn on the component you want to program—for example, to program your TV, turn on your TV set.

STEP 2: Point the Theta Digital remote toward the component that you want to program (in this case the TV set) and press and hold the component button (in this case the TV button).

While holding down the component button, begin to press numeric keys, one number at a time, starting from 1, continuing to 2, 3...0 until the component (in this case the TV) turns off.

STEP 3: Release the component button to save the code. The component LED light will blink three times to confirm that the code has been stored.

Repeat the above steps for other components.

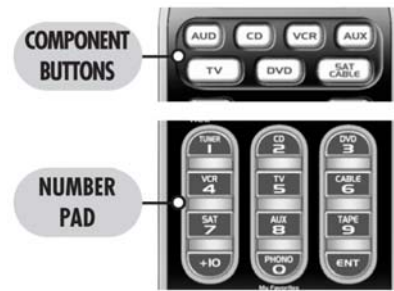

Three-Digit Code Entry Method

STEP 1: Find the 3-digit code numbers assigned to your brand from the lists in the back of this manual. The codes are listed by component category (i.e., TV, VCR, DVD, etc.), then by brand name. For instance, if you would like to locate a code for a Sony television, first locate the TV category and then look for the Sony brand.

STEP 2: Once you have located the 3-digit codes for each of the components that you wish to operate with your Theta Digital remote, write them ALL down on a piece of paper. It's important that you write down all the codes listed for your brand because only one code is going to work with your component.

STEP 3: Manually or using your old remote, turn on the component you want to program—for example, to program your TV turn on your TV set.

STEP 4: On the Theta Digital remote, press the Component button that you want to program (in this case the button that says TV) and the SELECT [SEL] button at the same time. Hold down both buttons for two seconds until the TV Component LED light turns on. This signals that you are in programming mode.



IMPORTANT: You have 30 seconds to perform the next step while you are in programming mode. If you do not press a button within 30 seconds, the component LED light will turn off. The remote will exit the programming mode and you will have to start over.

STEP 5: Point the Theta Digital remote toward the component (in this example the TV) and punch in the first 3-digit code that you wrote down for that specific component. Use the Number buttons 0~9 on the remote to punch in the code. The TV LED light will blink each time a number is pressed.

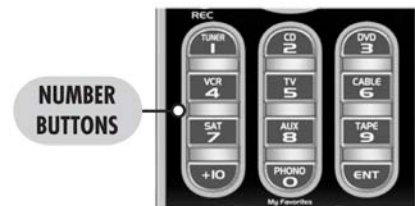

If the 3-digit code number you just punched in is the correct number, the component you are trying to program will turn off. If it did not turn off, enter the next code number from your list until it does turn off.

STEP 6: Once you've entered the code number and the component has turned off, press the POWER [ON] button on the Theta Digital remote to turn the component back on.

Next test the VOLUME and CHANNEL buttons (or PLAY and STOP buttons for VCR and DVD) to make sure they all work. For example, perhaps your Sony TV turned off with code number 147, but the volume controls did not work properly. In this case, try the next code number listed for that component. Repeat Step 5 using the next code number until you find a perfect match.

STEP 7: Once you've entered a correct code, **you must save it.** Press the component button you just programmed (in this case TV) one more time to save the code number. The component LED light will blink three times to confirm that the code was successfully stored. Now when you press the TV component button, all of the buttons will work with your TV.

Program the remaining components by repeating steps 3 through 7.

IMPORTANT: If you have tried all the setup codes in the list and the component still did not turn off after Step 5, either the Auto-Search Method (page 14) or the Learning Method (page 16) will help you program.

Auto-Search Method

The Auto-Search Method is a way you can scan through all of the codes in the table to find the right code for your component.

STEP 1: Manually or using your old remote, turn on the component you want to program—for example, to program your TV, turn on your TV set.

STEP 2: On the Theta Digital remote, press the Component button that you want to program (in this case the button that says TV) and the SELECT [SEL] button at the same time. Hold down both buttons for two seconds until the TV Component button light turns on. This signals that you are in programming mode.

IMPORTANT: You have 30 seconds to perform the next step while you are in programming mode. If you do not press a button within 30 seconds, the component LED light will turn off. The remote will exit the programming mode and you will have to start over.

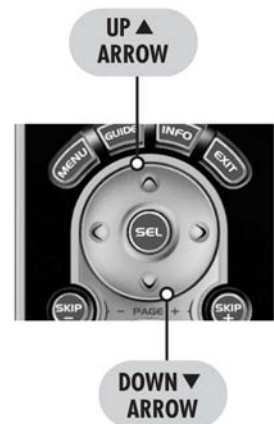

STEP 3: Point the Theta Digital remote control toward the component and press the UP arrow (or DOWN arrow) button once. Each time the UP or DOWN arrow button is pressed, the code will count up (or down) one code number and send a Power OFF signal. When the correct code is sent out, the component will turn off.

STEP 4: Once you have found the right code number and the component has turned off, press the POWER [ON] button on the Theta Digital remote to turn the component back on.

Next test the VOLUME and CHANNEL buttons (or PLAY and STOP buttons for VCR and DVD) to make sure they all work. If any of the buttons do not work properly, you need to find a new code. Continue pressing the UP (or DOWN) arrow button until you find a new code that turns off the component and makes the VOLUME or PLAY buttons respond correctly.

STEP 5: Once you have found the right code, you must save it. Press the component button you just programmed (in this case TV) one more time to save the code number. The component LED light will blink three times to confirm that the code was successfully stored. Now when you press the TV component button, all of the buttons will work with your TV.

NOTE: Use this method for those components you cannot program with either the Quick Set-Up or 3-digit Code Entry Methods.

IMPORTANT: If you cannot find the right code after 5 minutes of trying the Auto-Search Method, try the Learning Method (page 16).

Programming the Theta Digital remote using the Learning Method

STEP 1: Line up the Theta Digital remote to the remote control you want to “learn” from, head-to-head as shown below. Start with both remotes’ IR windows touching (or nearly touching).



STEP 2: On the Theta Digital remote, press the Component button that you want to program (in this case the button that says TV) and the ENTER [ENT] button at the same time. Hold down both buttons for two seconds until the TV Component button light turns on. This signals that you are in programming mode.

IMPORTANT: You have 30 seconds to perform the next step while you are in programming mode. If you do not press a button within 30 seconds, the component LED light will turn off. The remote will exit the programming mode and you will have to start over.

STEP 3: Press any button on the Theta Digital remote that you want to teach a command to. For example, if you want to teach the [MUTE] button on the Theta Digital remote the TV Mute command from the other remote, first press the [MUTE] button on the Theta Digital remote and the TV component button LED light will blink once indicating that the Theta Digital remote is ready to learn the command.

STEP 4: Press and hold the MUTE] button on the other remote until the component button LED on the Theta Digital remote blinks twice. Now you can continue learning all other buttons from your old remote by pressing the next button on the Theta Digital remote and repeating this step.

Note: The component LED will blink five times if there was an error in the learning process. In this case, please repeat Steps 3 and 4.

STEP 5: Once the Theta Digital remote has learned all the buttons in the selected component mode, press and hold the Component button and ENTER [ENT] buttons at the same time to save the learned functions. The component LED light will blink three times to confirm the programming. Now test all the buttons to make sure they learned correctly.

Repeat Steps 1-5 to program any other component modes.

If the Learning Method does not work, here are a few suggestions:

- If you have a Plasma TV, move to another room
- Avoid programming under fluorescent light or direct sunlight
- Put new batteries in the old remote
- Gradually vary the distance between the two remote controls
- Adjust the angles of the remotes (i.e., keep the Theta Digital remote on a flat surface while holding the other remote in hand and angling it down toward the Theta Digital remote)
- Tap the button on your old remote instead of pressing and holding it during the learning Process.

Here are some additional facts regarding the Learning process:

- Learned functions override any existing pre-programmed functions on the remote control
- Learned functions are automatically erased when a new function is learned on the same button
- Learned functions are retained even after a different set-up code number is programmed into the remote control
- To return to an original pre-programmed function, a learned function must be erased
- Rapidly tapping the Volume Up button on the old remote will teach the Theta Digital remote to ramp the volume instead of raising it in increments of one

AUX Function: Programming a 7th Component

After you've finished programming the Theta Digital remote for six primary components and you did not use AUX, you can take advantage of the AUX function to program a 7th component, such as a second TV, DVD, or any other audio/video component that you may have in your system. Simply program the [AUX] button in the same manner as any other component using either the Quick Set-Up Method, the 3-Digit Code Entry Method, the Auto-Search Method or the Learning Method.

Finding a Component's Set-up Code Number

If you used the Auto--Search or learning Methods to program a component, you may not know the code number you programmed. Here is a way for you to identify what that code number is, so you can make a note in the back of his Manual for future reference.

STEP 1: Press the component button you would like to verify and the SELECT [SEL] button at the same time for two seconds until the selected component LED light turns on.

IMPORTANT: You have 30 seconds to perform the next step while you are in programming mode. If you do not press a button within 30 seconds, the component LED light will turn off. The remote will exit the programming mode and you will have to start over.

STEP 2: Press the [INFO] button and count the number of times the Component LED light blinks. This number indicates the first digit of the code. Next it will pause for about one second and begin blinking again to indicate the number of the second digit. Then once again it will pause, then blink, to indicate the number of the third digit.

Example: One blink, pause, eight blinks, pause, three blinks indicates code number 183.

Note that ten (10) blinks represent the number 0.

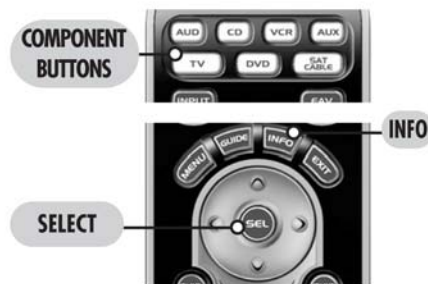

Programming Special Advanced Features

Programming Multi-Commands to Macro Buttons

The Theta Digital remote has 13 Macro buttons (ON, SYSTEM OFF, 7 Component buttons, and 4 “My Favorites” buttons) that are designed to store up to 20 commands in each button. Pressing any one of the Macro buttons will send out the series of commands that are stored in that particular button.

MacroString™ Total System On/Off

MacroString makes several devices work together by pressing one button. Imagine the convenience of turning on your TV, your DVD player and your Surround Sound receiver by pressing a single button on your Theta Digital remote. What could normally take three remotes and three button pushes, the Theta Digital remote can accomplish with the press of one button. We call that MacroString. Any of the Power On or the System Off buttons can be programmed for MacroString control. To set it up, follow these easy steps:

STEP 1: To program MacroString commands for the POWER [ON] button, press the POWER [ON] button and the [MUTE] button at the same time for two seconds until one of the component button LED lights turns on.



IMPORTANT: You have 30 seconds to perform the next step while you are in programming mode. If you do not press a button within 30 seconds, the component LED light will turn off. The remote will exit the programming mode and you will have to start over.

STEP 2: Press the component button you want to turn on and then the POWER [ON] button; repeat for all other components in the order you want them to turn on. The component LED lights will blink once each time you press the POWER [ON] button.



STEP 3: Once you've entered all the Power On commands, press the CHANNEL Up [CH] button to save your MacroString commands. The component LED lights will blink three times to confirm that the programming has been suc-



cessfully saved.

SUGGESTION: Most of the components have the same signal to turn the power On and Off. You may want to program MacroString only in the POWER [ON] button and save the SYSTEM OFF] button to turn components On or Off individually.

Note: If you want to program MacroString for the [SYSTEM OFF] button, repeat the same steps used for POWER [ON] programming.

Programming “My Favorites” Favorite

Channel Buttons

In Cable mode, the four [MY FAVORITES] buttons are also designed to serve as dedicated Favorite Channel buttons. Each button will access one of your favorite channels with just one button press. Here’s how to program Favorite Channels:

STEP 1: Press the [CABLE/SAT] button to select the Cable/SAT mode.

STEP 2: Press one of the [MY FAVORITES] buttons and the [MUTE] button at the same time for two seconds until the [CABLE/SAT] component LED turns on.

IMPORTANT: You have 30 seconds to perform the next step while you are in programming mode. If you do not press a button within 30 seconds, the component LED light will turn off. The remote will exit the programming mode and you will have to start over.



STEP 3: Using the Number Pad, punch in the Channel number of the Favorite Channel that you want to store in the Macro button. The CABLE/SAT component LED light will blink once for each button pressed.

STEP 4: Press the CHANNEL UP [CH▲] button to store the commands entered. The [CABLE/SAT] component LED will blink three times to confirm the programming.



Notes regarding programming multi-commands to Macro buttons:

- You can program up to 20 commands on each Macro button.
- You can program delays in between commands by pressing the [PAUSE] button. Each press adds a one-half second delay.
- Also, if you add the delay time as the first step of Macro commands, the remote will not send the Macro unless the button is held for two seconds. (This is the Press & Hold Function).
- You can also program macro commands in “layers” by pressing the [STOP] button in between commands. (For example, if you press [009], [STOP], [035], [STOP], [365], [STOP] in Step 3 of the Favorite Channel programming process) the remote will send out 009 at the first press of the selected [My Favorites] button, and then send out 035 at the second press, etc.
- You cannot program the [CH▲] or [PAUSE] buttons as macro commands.

LevelControl™ Total System

Volume Control

LevelControl is one of the most exciting features of the Theta Digital remote. It gives you total volume control over ALL the components in your system, even those that do not have built-in volume control, such as TIVO, DVD and VCR. LevelControl saves you the hassle and inconvenience of constantly switching between component modes just to control volume.

First you should identify which device in your system will be used to deliver sound. In a basic system, the sound may come from your TV speaker. In a more advanced system, the sound may come from your audio components (such as a Surround Sound Receiver or Home Theatre system).

Now, let's set-up LevelControl. Here's how:

STEP 1: Press and hold the button that corresponds to the Component you want to add volume control to (such as a DVD or VCR) and the SELECT (SEL) button at the same time for about three seconds until the component LED light turns on.

IMPORTANT: You have 30 seconds to perform the next step while you are in programming mode. If you do not press a button within 30 seconds, the component LED light will turn off. The remote will exit the programming mode and you will have to start over.

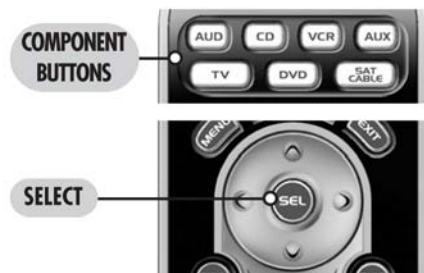

STEP 2: Press the VOLUME UP [VOL▲] button and then press either the TV or AUDIO component button that you want to use for volume. The Component LED light will blink three times to confirm that it is saved. This sets up three buttons (Volume Up, Volume Down and MUTE) as a group for that component.

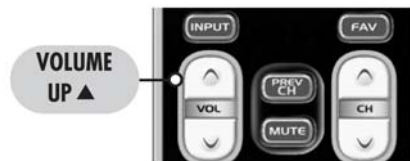

Repeat Steps 1-2 for all other components.

Note: LevelControl is what's technically referred to as a "Punch Through" feature and is not limited to volume control. It can also be applied to other groups of buttons. If you find yourself switching to a particular component mode frequently to access a particular control, consider using Punch Through.

Channel Control “Punch Through”

This “punch through” enables you to program the Theta Digital remote so that either the Cable or TV Channel Controls (CHANNEL UP, DOWN, LAST, CHANNEL NUMBERS 0-9, +10 and ENTER) will also operate in other component modes on the remote control.

STEP 1: Press and hold the component button you want to add channel control to, such as [DVD] or [VCR], and the SELECT [SEL] button at the same time for two seconds until the Component LED light turns on.

IMPORTANT: You have 30 seconds to perform the next step while you are in programming mode. If you do not press a button within 30 seconds, the component LED light will turn off. The remote will exit the programming mode and you will have to start over.

STEP 2: Press the CHANNEL UP [CH ▲] button. The component LED light will blink once.

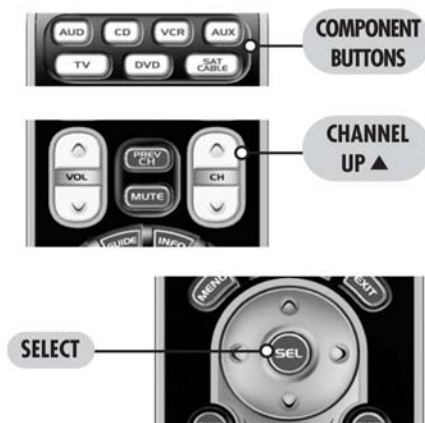

STEP 3: Press either the [TV] or [CABLE/SAT] button that you want to use as the source of channel control. The component LED will blink three times to confirm it is saved.

Transport Control “Punch Through”

This “punch through” enables you to program the Theta Digital remote so that VCR or DVD Transport Controls (PLAY, STOP, FF, REW, PAUSE, SKIP and RECORD) will also operate in other component modes on the remote control.

STEP 1: Press and hold the component button you want to add Transport Control to, such as [CABLE/SAT] or [TV], and the SELECT [SEL] button at the same time for two seconds until the Component LED light turns on.

IMPORTANT: You have 30 seconds to perform the next step while you are in programming mode. If you do not press a button within 30 seconds, the component LED light will turn off. The remote will exit the programming mode and you will have to start over.

STEP 2: Press the [PLAY] button. The ▲ component LED light will blink once.

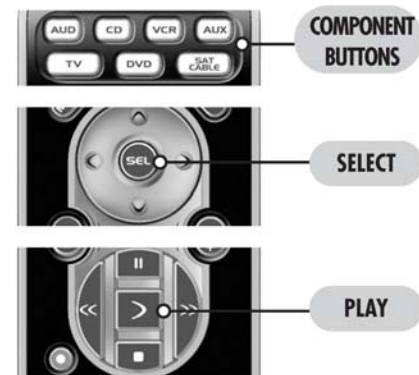

STEP 3: Press either the [DVD] or [VCR] button that you want to use as the source of Transport Control. The component LED will blink three times to confirm it is saved.

OSD (On-Screen Display) Control

“Punch Through”

This “punch through” enables you to program the Theta Digital remote so that CBL or DVD OSD Controls (MENU, GUIDE, INFO, EXIT, SEL and 4 Cursor Controls) will also operate in other component modes on the remote control.

STEP 1: Press and hold the component button you want to add OSD Control to, such as [TV] or [VCR], and the SELECT [SEL] button at the same time for two seconds until the Component LED light turns on.

IMPORTANT: You have 30 seconds to perform the next step while you are in programming mode. If you do not press a button within 30 seconds, the component LED light will turn off. The remote will exit the programming mode and you will have to start over.

STEP 2: Press the [MENU] button. The component LED will blink once.

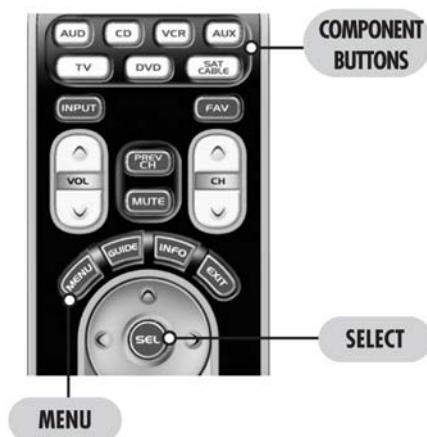

STEP 3: Press either the [CABLE/SAT] or [DVD] button that you want to use as the source of OSD Control. The component LED will blink three times to confirm it is saved.

Erasing Commands - Overview

You can erase a single learned command, all learned commands in each component mode, LevelControl programming, MacroString commands, or re--set the remote to original factory default settings.

Erasing a Single Learned Command from One Component

STEP 1: Press the component button where the learned command is stored and the [ENTER] button at the same time for two seconds until the component LED light turns on.

IMPORTANT: You have 30 seconds to perform the next step while you are in programming mode. If you do not press a button within 30 seconds, the component LED light will turn off. The remote will exit the programming mode and you will have to start over.

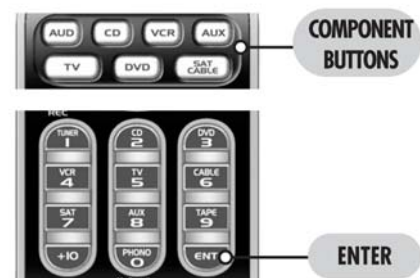

STEP 2: Press and hold the button you want to erase for two seconds. The component LED light will blink twice to confirm the erasure.

STEP 3: Repeat Step 2 to erase any other

buttons in the selected component mode.

STEP 4: To exit Erase mode, press and hold both the component button and the [ENTER] button at the same time until the component LED light blinks three times.

Erasing All Learned Commands from One Component

This function allows you to erase all the learned commands from one component. For example, if you want to erase all learned commands on the TV component button because you bought a new TV, the process is very simple.

STEP 1: Press the component button where all the learned commands are stored and the [ENTER] button at the same time for two seconds until the component LED turns on.

IMPORTANT: You have 30 seconds to perform the next step while you are in programming mode. If you do not press a button within 30 seconds, the component LED light will turn off. The remote will exit the programming mode and you will have to start over.

STEP 2: Press and hold both the component button you want to erase and the [PAUSE] button at the same time for two seconds, until the component LED light blinks twice to confirm the erasure.

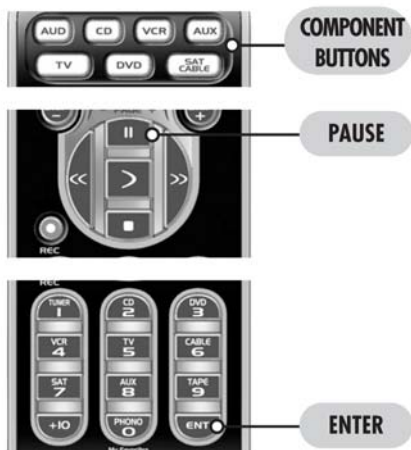

STEP 3: To exit Erase mode, press and hold both the component button and the [ENTER] button at the same time until the component LED light blinks three times.

Erasing MacroString & Other Macro Commands

STEP 1: To erase MacroString commands on the POWER [ON] or [SYSTEM OFF] button, press and hold either the POWER [ON] or [SYSTEM OFF] button and the [MUTE] button simultaneously for two seconds until the current status component LED turns on.

IMPORTANT: If you don't proceed to the next step within 30 seconds, the LED will turn off and exit set-up mode and you will need to start over.

STEP 2: Press the CHANNEL UP [CH] button to erase and exit Erase mode. The component LED light will blink three times to confirm the erasure.

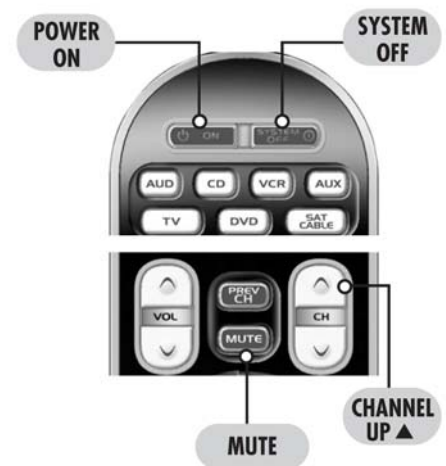

NOTE: To erase other Macros, simply press the appropriate button in Step 1 in combination with the [MUTE] button.

Erasing LevelControl & Other “Punch Through” Commands

STEP 1: Press and hold the Component button you want to erase volume control from, such as DVD or VCR and the SELECT [SEL] button at the same time for two seconds until the Component LED light turns on.

STEP 2: Press the VOLUME UP [VOL▲] button and the same component button from Step 1. The component LED light will blink three times to confirm the erasure. Repeat Steps 1--2 to erase LevelControl commands from other components.



Repeat Steps 1--2 to erase LevelControl commands from other components.

NOTE: To erase other “punch through” commands, simply press the following buttons in place of VOLUME UP in Step 2:

- For Channel Control, press: CHANNEL UP [CH ▲]
- For Transport Control, press: PLAY [▶]
- For OSD Control, press: [MENU]

Factory Reset

You can reset your Theta Digital remote remote to the original factory default settings.

Press and hold both the [TV] and RECORD [REC] buttons for about five seconds until the [CABLE/SAT] component LED light blinks five times. All programming and set-up codes that you have entered into the remote will be erased and the Theta Digital remote will return to the original factory default settings.

Warning

This procedure will erase all programming and set-up codes that you have entered into the remote.

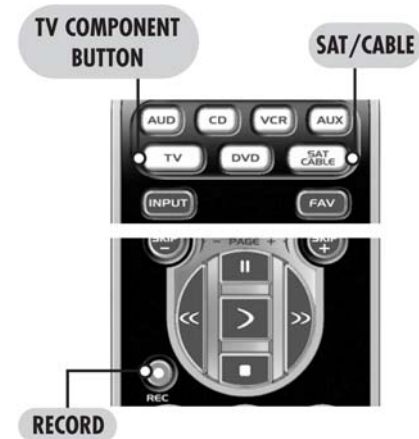

Pre-Programmed Code Tables

The Theta Digital remote Pre-Programmed code library is classified by category (Audio, CD, VCR/DVR, etc.).

Within each category, the code numbers are listed in rows by brand (Sony, Panasonic, B & K, etc.). Some brands have more than one three-digit code.

Circle the correct row and refer to it while you perform setup operations.

AUDIO	Theta Digital Casablanca III HD, Amps, Preamps & A/V Receivers	36-37
DVD	Theta Digital Compli-Blu, DVD Players & Recorders	37-39
VCR/DVR	VCRs, DVRs & Combo Units	39-40
AUX	Theta Digital Generation VIII, iPod, Media PC, Gaming System, Lighting Controls	40-41
CD	CD Players & Changers	41-42
TV	TVs, Plasmas, Projectors & Monitors	42-45
CABLE/SAT	Cable Set Top Boxes & Satellite Receivers	45-46

Brand	AUDIO Code Numbers
ADC	007
ADCOM	082 092 225 161 269 355 356
AIWA	170 018 104 202 203 213 211 188
AKAI	189
AMC	125 126 127 281 282
ANGSTROM	142
ANTHEM	335 337
ARCAM	141 418
ATLANTIC TECHNOLOGY	342
AUDIO FILE	071
AUDIO MATRIX	167
AUDIO TECHNICA	134
B & K	096 097
BOSE	070 170 224 347 409 460
BOSTON ACOUSTICS	447
BRIX	555
CARVER	006 028 061 071 201 214 226 185 022 077 284
CINEMA SOUND	134
CITATION	148 272
CLARION	026
DELPHI	515
DENON	109 215 230 234 330 001 801
DVICO	802
ELAN	057 290
ENLIGHTENED AUDIO	099 098
ESCIENT	368 451
FISHER	047 214 182 297
FLEXTRONICS	378
FOSGATE AUDIONICS	231 342
GE	056
GOLDSTAR	008
HARMAN KARDON	231 233 153 154 118 318
HITACHI	020
INTEGRA	275 781
INSIGNIA	589
JAMO	398 799
JCPENNEY	216
JENSEN	058
JVC	163 191 114 279 291
KENWOOD	026 066 145 192 182 005 280 374
KLH	331
KOSS	216
KRELL	072 376 384
KYOCERA	007
LEXICON	120 235 236 237 357 360
LINN	124 377
LUXMAN	139 052 165 115 004 009
LXI	056
MAGNAVOX	086 164 152 208
MARANTZ	006 028 031 040 063 185 479 251 265 119 289
MCINTOSH	238 286
MERIDIAN	100 012 013
MITSUBISHI	242 243 204
MONDIAL	157 158 042 043 081 112
MYRYAD	276 293
NAD	113 283 478 479
NAKAMICHI	040 244 245 172 183 287
NEC	176
NIRO	343
NILES	403
ONKYO	017 046 108 080 209 275
OPTIMUS	026 041
OUTLAW	342
PANASONIC	032 195 219 177 292 383
PARASOUND	129 130 132 261 294 295 333 334
PHILIPS	249 250 251 063 119 805
PIONEER	014 039 044 069 168 116 035 078 198 480
POLKAUDIO	515
PROCEED	144 268
RCA	010 048 117 156 067 288
REALISTIC	019 056 073 075 095

AUDIO (continued)

Brand	Code Numbers
ROTEL	074 083 085
RUSSOUND	379 391 392
SAMSUNG	016 804
SANSUI	040 048 110 119 065 228
SANYO	047
SCOTT	019 091
SHARP	026 094 026 175
SHERWOOD	024 102 106 447
SIRIUS	555
SONY	018 247 248 166 101 184 218 271 369 372 380 800
SOUNDESIGN	036
SSI	068
SUNFIRE	344 345 346
TEAC	005 019 049 040 212 217
TECHNICS	122 176 193 219 178 177 200 257 262
THETA DIGITAL	001, 136
TOSHIBA	060 087 198 278
XM SATELLITE RADIO	515
YAMAHA	026 253 169 067 173 264 232 089 264 274 285 373 803
ZENITH	143 210

SATELLITE Radios

BRIX	555
DELPHI	515
POLK AUDIO	515
SIRIUS	555
SONY	380
XM SATELLITE RADIO	515

DVD

Brand	Code Numbers
AIWA	146
AKAI	281
ALPINE	098
APEX DIGITAL	087 282 115
BROKSONIC	130
CINEVISION	091
COBY	260
CYBERHOME	271
DENON	138 080 173
DURABRAND	091
DVD 2000	017
EMERSON	091 143
ESA	143
FISHER	147
FUNAI	143
GE	027
GO VIDEO	137 091 220 221 265
GOLDSTAR	091
HARMAN KARDON	084 140
HITACHI	101
ILO	268
INITIAL	282
INSIGNIA	143
INTEGRA	142 338
JBL	084
JVC	012
KENWOOD	151
KISS	279
KLH	135
KRELL	104
LEXICON	148
LG 091	057
LITEON	264 265
MAGNAVOX	001 096 143 282
MALATA	267
MARANTZ	083 095
MERIDIAN	153
MICROSOFT	027
MINTEK	282
MITSUBISHI	017
MYRYAD	102 134
NAD	088

DVD (Continued)

Brand	Code Number
NAKAMICHI	103
ONKYO	076 141 142 338
OPPO	266 341
OPTIMUS	107
ORION	130
PANASONIC	042 138 144 150 285
PHILIPS	001(Default) 083 095 166 344
PHILIPS-MAGNOVOX	141 001
PIONEER	023 092 099 107 108 131 304
POLAROID	233
POLK AUDIO	141 001
PROSCAN	027
RCA	027
RJTECH	269
SAMSUNG	056 165 170 137 159 275
SANSUI	130
SANYO	147
SEARS	130
SENSORY SCIENCE	265
SHARP	094
SONY	033 118 145 126 191 286 242 243 343
SUPERSCAN	143
SV2000	143
SYLVANIA	143
SYMPHONIC	143
TATUNG	102
TEAC	107
TECHNICS	042
TECHWOOD	088
THOMPSON	027
TOSHIBA	130 141 164 188 273
VENTURER	149
X-BOX	027
YAMAHA	042 089 166 138 197 334
ZENITH	057 091

BLU-RAY & HD DVD

LG	091
PANASONIC	285
PIONEER	304
SAMSUNG	275
SONY	286
TOSHIBA	273

DVD Recorders

CYBERHOME	271
GO VIDEO	220 221 265
ILO	268
KISS	279
LITEON	265
PANASONIC	138
SENSORY SCIENCE	265
SONY	191
TOSHIBA	188

TV/DVD Combos

Brand	Code Numbers
AIWA	146
AKAI	281
DURABRAND	143
ESA	143
FUNAI	143
INSIGNIA	143
MAGNAVOX	282
MINTEK	282
SAMSUNG	165
SV2000	143
SYLVANIA	143
SYMPHONIC	143
TOSHIBA	130

TV/DVD/VCR Combos

EMERSON	143
INSIGNIA	143
MAGNAVOX	143
PANASONIC	144
SUPERSCAN	143
SYLVANIA	143
TOSHIBA	164

DVD/VCR Combos (Continued)

GO VIDEO	137
PANASONIC	150
PHILIPS	001 (VCR Functions for VCR 067)
SAMSUNG	137 159
SANSUI	130
SONY	145 191
TOSHIBA	141
ZENITH	091 (VCR Functions for VCR101)

VCR/DVR

Brand Code Numbers

VCRs	
AIWA	034
AKAI	043
AMPRO	072
ANAM	145
AUDIO DYNAMICS	012 043
BROKSONIC	129
CANON	145
CRAIG	003 135
CURTIS MATHES	145
DAEWOO	010 112
DBX	012 043
DYNATECH	034 053
ELECTROHOME	059
EMERSON	006 145 034 101 129 131 153
FISHER	003 010 008
FUNAI	034
GE	145 072 147 144
GOLDSTAR	101 013 012 123
HARMAN KARDON	012
HITACHI	004 034 043 013
INSTANTREPLAY	145
JCL	145
JCPENNEY	012 013 101
JENSEN	043
JVC	048 043 012 145
KENWOOD	048 034
LG	101 013 012 123
LLOYD	034
LXI	034 003
MAGNAVOX	067 145 034
MARANTZ	067 012 145
MARTA	101
MEI	145
MEMOREX	101 003 010 145 034 053 072 102
MGA	059
MINOLTA	013
MITSUBISHI	059 013
MTC	034
MULTITECH	034
NEC	012 043 048
NORDMENDE	043
OPTONICA	053
PANASONIC	070 145 167
PENTAX	013 145
PHILCO	145 034 067
PHILIPS	145 067 034 101
PILOT	101
PIONEER	013 048
PULSAR	072
QUASAR	145
RADIO SHACK	123
RCA	144 147 145 013 034
REALISTIC	003 008 010 145 034 053
RICO	101
SAMSUNG	102 112
SANSUI	043 048 135
SANYO	003 010 102
SCOTT	112 129 131
SEARS	003 008 010 013 101 112
SHARP	149 145
SIGNATURE	034
SONY	057 058 003 145 149 154
SOUNDESIGN	034
STS	013
SYLVANIA	145 034 059 067

VCR/DVR COMBOS (Continued)

Brand	Code Numbers
SYMPHONIC	034
TANDY	010 034
TATUNG	043
TEAC	034 043
TECHNICS	145 070
TEKNIKA	145 034 101
THOMAS	034
TMK	006
TOSHIBA	112 131 008 059 013
TOTEVISION	101
VECTOR RESEARCH	012
VICTOR	048
VIDEO CONCEPTS	012 034
WARDS	003 013 145 034 053 131
YAMAHA	012 034 043
ZENITH	072 048 101 034 058

TV/VCR Combos

EMERSON	153
FUNAI	034
GOLDSTAR	101 123
HITACHI	034
JCPENNEY	101
LG	101 123
LLOYD	034
MAGNAVOX	034 067
MEMOREX	101
PANASONIC	070 167
PHILIPS	034 067
RADIO SHACK	123
RCA	034
SEARS	101
SONY	057 154
SYLVANIA	067
SYMPHONIC	034
THOMAS	034
ZENITH	034

PVR, TIVO

HUGHES	001 (Default)
HUMAX	001
PHILIPS	001
REPLAY NETWORKS	775
SONY	804 805
TIVO	001
TOSHIBA	001

AUX

Brand Code Numbers

D2A	
ARTEC	586
CASTI	587
CRAIG	588
DIGITAL STREAM	609
GRIDLINK	592
INET ACCESS	589
INSIGNIA	567
LASONIC	592
MAGNAVOX	584
RCA	585
SANSONIC	592
THETA DIGITAL	001 (Default)
TIVAX	589 590
ZENITH	567
ZENTECH	610
ZINGWELL	591 593

LIGHTING CONTROLS

LIGHT-TOUCH	208 257
LUTRON	158 159 077
X-10	183 093

PC & iPod Controls

APPLE	401 412 476
BOSE	409
DLO	418
GRIFFIN	471
IPORT	419
KENSINGTON	406
SONACE	419
TEN TECHNOLOGY	401

AUX (Continued)

Brand Code Numbers

MEDIA PC CONTROLS

DELL 001 262
 GATEWAY 001 262
 HAUPPAUGE 294 295
 HP 001 (Default) 262
 KEYSpan 297
 SONY 001 262
 TOSHIBA 001 262
 WINBOOK 001 262

GAMING SYSTEM CONTROLS

MICROSOFT/XBOX408 107
 SONY/PS2 414
 SONY/PS3 598
 AUDIO AUTHORITY/PS3 622

CD

Brand Code Numbers

ADCOM 062 042
 AIWA 089 170 187
 AKAI 202
 AMC 231 232
 ARCAM 238
 AUDIOACCESS 119 147
 AUDIO EASE 165
 AUDIO TECHNICA 046
 CALIFORNIA AUDIO 147 008
 CARVER 185 041 050 107 130 134 135 138 139
 203 204 167
 CREEK 159
 DENON 002 123
 EMERSON 042
 FISHER 050 185 134 008
 GENEXXA 010
 HARMAN KARDON 033 047 208
 HITACHI 042 175
 INKEL 130
 JCPENNEY 141
 JENSEN 158
 JVC 004 022 136 163 213 214 242 243
 KENWOOD 185 007 023 055 071 072 142 137 254
 KRELL 241 255
 KYOCERA 005
 LUXMAN 011 028 070 249 252
 MAGNAVOX 107
 MARANTZ 041 051 077 107 209 246
 MCINTOSH 212 247
 MEMOREX 010
 MISSION 107
 MITSUBISHI 179
 MONDIAL 147
 MYRYAD 244 155
 NAD 005 178
 NAKAMICHI 217 218
 NEC 062
 NIKKO 046
 NSM 107
 ONKYO 030 038 039 168 169
 OPTIMUS 010 050 081
 PANASONIC 147 172 008 068 248
 PARASOUND 233 240
 PHILIPS 041 107 246
 PIONEER 010 020 174 175 176
 PROCEED 239
 PROTON 07
 QUASAR 147 008
 RCA 017 042 150
 REALISTIC 042 050 051 187
 ROTEL 107 161 178 250
 SAE 107
 SANSUI 107 128 171 190 125
 SANYO 050
 SHARP 026 031 051
 SHERWOOD 051 096 112 115 119 166
 SIGNATURE 033
 SONY 048 081 097 126 133 177 001 (Default)
 226 164
 SOUNDESIGN 251

CD(Continued)

Brand Code Numbers

SUMO 155
 SYLVANIA 107
 SYMPHONIC 052
 TANDY 010
 TEAC 051 052 233 079
 TECHNICS 147 172 184 008 068
 THETA DIGITAL 234 235
 VICTOR 004 022
 WARDS 185 033
 YAMAHA 024 046 054 186 183 245

TV

Brand Code Numbers

ABEX 025
 ADMIRAL 072 251 333 160
 ADVENT 247
 ADVENTURA 002
 AKAI 197 146 248 473 474 475 405
 A MARK 112 143
 AMPRO 167 073
 AMSTRAD 052
 ANAM 043 054 056 080 112
 AOC 197 363 112 058
 APEX DIGITAL 006 591
 AQUAVISION 573 574
 ASTAR 477
 AUDIOVOX 076
 BELCOR 116
 BELL&HOWELL 333 072
 BROKSONIC 238
 BROCKWOOD 116
 CAIRN 201
 CANDLE 197 002 003 363
 CAPEHART 058
 CELEBRITY 001
 CENTURION 197
 CETRONIC 043
 CITIZEN 197 002 003 363 043 258 103 143
 CLASSIC 043
 CLP CLASSIC 333
 COLORTYME 116 197
 CONCIERGE 073
 CONCERTO 363
 CONTEC 043 050 051
 CORNEA 116
 CORONADO 143
 CRAIG 043 054
 CROWN 043 143
 CURTIS MATHES 197 258 363 143
 CXC 043
 DAEWOO 363 043 076 103 127 143
 DAYTRON 363 143
 DELL 319 320
 DIGITAL PROJECTION 570
 DIMENSIA 333
 DREAMVISION 235
 DUKANE 011 025
 DUMONT 116 073
 DURABRAND 096
 DWIN 177 257
 DYNASTY 043
 DYNATECH 062
 DYNEX 399
 EIKI 187
 ELECTROBAND 001
 ELECTROGRAPH 470
 ELECTROHOME 143 024 076 196
 ELEKTRA 072
 ELEMENT 363 494
 EMERSON 028 048 043 155 005 197 363 047
 050 051 076 096 143 151 153 154
 ENVISION 116 197
 ESA 323
 FISHER 007 057
 FUJITSU 198 246 346

TV (Continued)	
Brand	Code Numbers
FUNAI	028 043 052
FUTURETECH	043
GATEWAY	242 268
GE	160 144 165 073 197 008 009 034 056 074 130 155 333 363
GEM	391
GIBRALTAR	116 073
GOLDSTAR	113 116 102 363 106 112 127 143
HALL MARK	363
HAIER	164 363
HANNSPREE	381
HISENSE	419 442
HITACHI	011 166 363 009 010 012 023 075 143 158 072 250 587
HP	316 327 378
HUMAX	518
ILO	472 399
INFINITY	164
INFOCUS	330 333 547 548 532
INTEQ	073
INSIGNIA	350 354 457 399 164 454
JANEIL	002
JBL	164
JCB	001
JCPENNEY	363 024 197 008 009 030 065 258 143 160
JENSEN	013
JVC	038 034 001 083 199 210 240 406 581
KAWASHO	116 001 197
KEC	043
KENWOOD	197 001
KLEGG	470
KLOSS	002 059
KMC	143
KONKA	457
KREISEN	530
KTV	043 197 143 154
KURAZAI	072
LG	113 116 102 106 112 127 143 284 363 569 576
LODGENET	072
LOEWE	164
LOGIK	072
LUXMAN	363
LXI	166 007 138 052 251 160 164
MAGNAVOX	164 059 197 003 060 061 363 063 363 063 064 127 022 160 094 226 467
MAJESTIC	333 072
MARANTZ	197 164
MATSUI	164
MAXENT	242
MEGATRON	116 197 011
MEMOREX	007 072 363
MGA	197 363 024 028 042
MIDLAND	333 073
MINUTZ	008
mitsubishi	109 124 024 363 028 042 146 348 450
MONTGOMERYWARD	333 072
MTC	197 363 062 258
NAD	138 025
NEC	130 134 197 040 024 056 019 237 262 272 575 577
NET TV	202
NIKEI	043
NIKKO	116 197
NIKO	527
NORCENT	390
NUVISION	351 567
OLEVIA	432 363
ONKING	043
ONWA	043

TV (Continued)	
BRAND	CODE NUMBERS
OPTIMUS	025
OPTONICA	019 251
OPTOMA	265 270 249
ORION	096
PANASONIC	034 056 080 164 208 524 583
PHILCO	197 003 059 060 064 164 363 024 056 063
PHILIPS	164 005 093 038 197 003 363 059 127 206 333 431 594
LUXMAN	363040
PILOT	116
PIONEER	135 025 197 018 023 116 234 272 374 393
POLAROID	323 328 353 354 356 457 494 505
PORTLAND	363 143
PROSCAN	144 160 333 165 167
PROTON	363 112 058 143 171 172 193
PROTRON	498 499 392 398
PROVIEW	494
PROX	572
PULSAR	116 073
QUASAR	034 056
RADIO SHACK	019 363 143 043 127
RCA	160 165 065 144 197 363 024 056 152 023 074 333 588
REALISTIC	007 019 043 047
REVOLUTION HD	470
RUNCO	072 169 178 179 180 181 182 073 342 416 395
SAMPO	197 058 363 202
SAMSUNG	050 089 105 363 127 143 160 228 229 258 578
SAMSUX	197
SANSUI	096 399
SANYO	166 007 020 053 057 082 187
SCEPTRE	276
SCOTCH	116 197
SCOTT	028 043 363 048 143 497
SEARS	138 030 363 007 028 057 143 094 160 082 165 166
SELECO	189 200 205 011
SHARP	019 014 028 029 363 022 143 175 251 308 496
SHOGUN	116
SIGNATURE	072
SIMPSON	003
SONY	001(Default) 147 185 085 213 277 279
SOUNDESIGN	028 363 003 043
SOYO	528
SPECTRICON	112
SPECTRONIQ	499
SSS	363 043
SUPRA	116
SUPREMACY	002
SUPREME	001
SVA	328
SYLVANIA	197 003 052 059 060 063 064 164 160 127 593
SYNTAX OLEVIA	333 144 160 376 432 363
TANDY	251
TATUNG	056 062
TECHNICS	034 080
TECHWOOD	363
TEKNIKA	002 003 363 024 028 043 072 258 143
TELEFUNKEN	037 046

TV (Continued)

Brand	Code Numbers
TELERENT	072
TERA	172
TMK	363
TOSHIBA	138 030 007 040 062 258 325
TOTEVISION	143
TRUTECH	529
UNIVERSAL	008 009
VICTOR	038
VIDEO CONCEPTS	146
VIDIKRON	174 164 188 192 342
VIDTECH	363
VIEWSONIC	242 433
VIKING	002
VIORE	472 592
VISCO	494
VITO	363
VIZIO	391 063
WARDS	363 008 009 019 028 060 061 063 064 072 074 143 164 034
WESTINGHOUSE	076 276 001
YAMAHA	197 363 370 372 408
YORK	363
YUPITERU	043
ZENITH	073 072 095 103 284
ZONDA	112

CABLE/SAT

Brand	Code Numbers
CABLE BOXES	
ABC	004 042 053
ADB	315 254 255 259
ADELPHIA	001 074
ADVANCED NEWHOUSE	001
ALTRIO	001
AMERICAST	099
AMINO	256 257 260 261
ARMSTONG	074
AT&T BROADBAND	074 035
ATLANTIC BROADBAND	001 074
BELL SOUTH	099
BLUE RIDGE	001 074
BRESNAN	074
BRIGHT HOUSE	001 110
BUCKEYE COMM	074
CABLEVISION	001 074 108
CHARTER	001 074
CISCO	001 041 042 045 313 035
COGECO	074
COMCAST	001 074 110 313
COMSAT	074
COX DIGITAL	001 074
DIGEO	111
EAGLE	020 030
EASTERN	057
ENTONE	316 258
GEMINI	008
GENERAL INSTRUMENT	074 104
GNC	099
GOLDEN CHANNEL	030
HAMLIN	049 055
HITACHI	055
INSIGHT	074
JERROLD	074 004 002 008 009 010 069
MAGNAVOX	010 012
MASSILLON	074
MEDIACOM	074
MOTOROLA	074 110 148 111 112 036
MOXI	111 252 086
MYRIO	254 255
NCTC	074
NOW TV	314
NSC	015 038
OAK	031 053

CABLE/SAT (Continued)

Brand	Code Numbers
PACE	001 074 110 313
PANASONIC	044 047
PHILIPS	006 012 013 020 085
PIONEER	001(Default) 034 051 063 105
QUEST	112
RCA	047
RCN	074
REGAL	049
REGENCY	057
RODGERS	001
SAMSUNG	030
SCIENTIFIC ATLANTA	001 041 042 045 035
SEREN	001
SERVICE ELECTRIC	074
SHAW	074
SIGECOM	001
SONY	108
SPRUCER	047
STARCOM	002 004 008 009
STARGATE	008 030 104
SUSQUEHANNA	001 074
TELNET	154
TIME WARNER	001 074
TOCOM	056
UNITED CABLE	004 053
VERIZON	110
VIDEOTRON	001
VIEWSTAR	012 015
WEGENER	250
WIDE OPEN WEST	001 099
ZENITH	093 100

SATELLITE RECEIVERS

Brand	Code Numbers
CABLEVISION	148
DIRECTV	173
DISH NETWORK	122
ECHOSTAR	122
EXPRESSVU	122
GENERAL ELECTRIC	116 150
GENERAL INSTRUMENT	148
GOI	122
HITACHI	139 140
HTS	122
HUGHES	114
JVC	122
LG	170
MITSUBISHI	114
MOTOROLA	148
NEXT LEVEL	148
NFUSION	192
PANASONIC	142 160
PHILIPS	152 153 156 114
PROSCAN	116 150
RADIOHACK	148
RCA	116 150
SAMSUNG	155 163 169 175
SKY	164
SONY	115
STAR CHOICE	148
TOSHIBA	127 114 158
VOOM	148

Frequently Asked Questions

If the batteries run out, will I lose my settings?

No, the Theta Digital Remote stores all of your settings in non-volatile FLASH memory. You could remove the batteries for months, replace them at your convenience, and the Theta Digital Remote would still remember all your settings.

What is MacroString?

MacroString is a very useful way to make a lot of things happen with one button push. For example, in most home theaters, to watch television, the user must turn on the TV, then turn on the Cable Box or the Satellite Receiver, then turn on the Surround Sound system for sound. Instead of pressing all of those buttons one at a time, MacroString allows you to turn on all of these components with one button Push. For more information on why and how you should program MacroString commands, please refer to page 21 of this manual.

What if my remote control no longer works from a distance?

Replace the batteries with new Alkaline batteries.

Who can I contact for more answers?

Theta Digital's technical support and customer service staff are ready to answer any questions you may have.

E-Mail us at support@ati-amp.com

Visit our website: www.thetadigital.com

Call us at (323) 278-0001 ext. 112.

USA Limited Warranty

Amplifier Technologies, Inc. (ATI) warrants this product against defects in material or workmanship for a period of one (1) year as set forth below. ATI will, at its sole option, repair the product using new or comparable rebuilt parts, or exchange the product for a comparable new or rebuilt product.

This warranty does not apply to the following:

- Units purchased from unauthorized resellers.
- Units purchased second-hand (used)
- Units installed or deployed for rental or commercial use.
- Damage caused by misuse, neglect, or acts of nature.
- Products that have been modified or incorporated into other products.
- Products purchased more than 12 months ago.

Specifications

Learning Capability

.....80 buttons for any component

Macro Capability

.....13 Macros of up to 20 steps each

Non-Volatile Flash Memory

.....64 Kbyte

IR Range (Line of Sight via Infrared)

.....30-50 feet, depending on operational environmental conditions

Weight.....6.0 Oz (with batteries)

Size.....2 1/8"W x 8 3/4"H x 1 1/8"D

Batteries.....Two AA Alkaline batteries (included)